

# Lafayette A



## INFORMATION ABOUT THIS PLAN:

- 3 Bedroom, 2.5 Baths
- Up to 2,788 SF
- Formal living room
- Flex room
- Organizational space
- Loft
- Options include dining room, office, guest suite, butler's pantry, pet pad, 3rd floor bonus, 2nd guest suite and 4th bedroom



**B**



**C**

# Lafayette

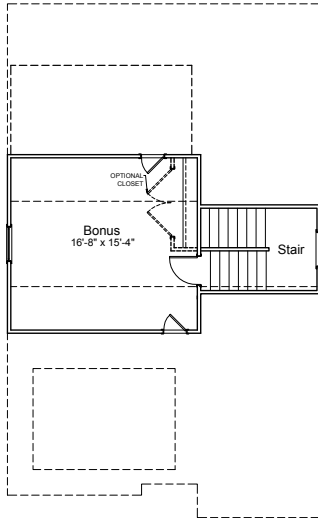

**3rd Floor Bonus Option**

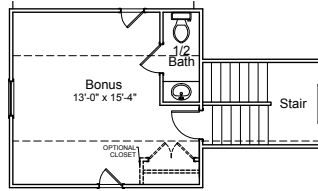

**Half Bath Option @ Bonus**

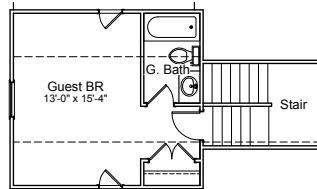

**Guest Suite #2 Option I.L.O. Bonus**

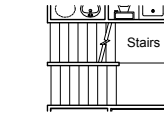

**Stair to 3rd Floor Bonus**

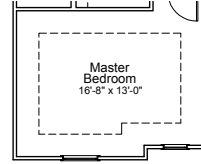

**Boxed Ceiling Opt.**

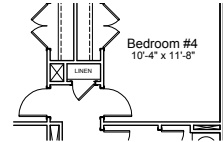

**Bedroom #4 Option I.L.O. Loft**

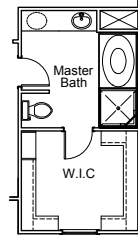

**Tub/Shower Option**

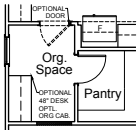

**Org. Space Cabinet Option**

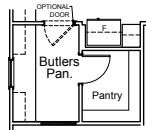

**Butler's Pantry Opt. I.L.O. Org. Space**

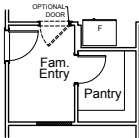

**Family Entry Opt. I.L.O. Org. Space**

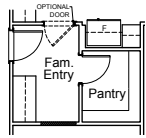

**Family Entry Cabinet Option I.L.O. Org. Space**



**Office Option I.L.O. Flex**

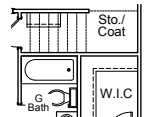

**Guest Suite Option I.L.O. Flex**

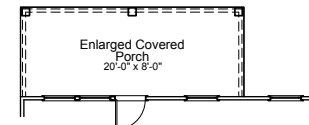

**Enlarged Covered Porch Option (Not Available w/ Attached Garage Opts.)**

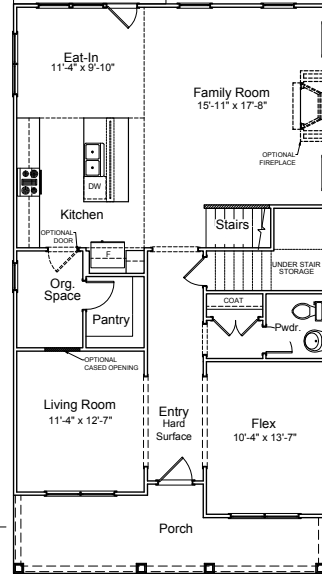
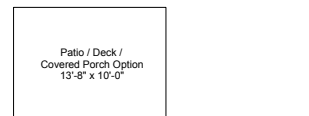

**"A" 1st Floor Plan**

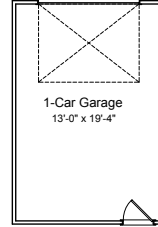

**1-Car Garage Option**

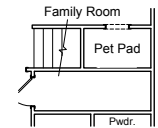

**Pet Pad Option**

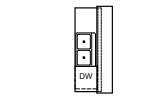

**Raised Bar Option**

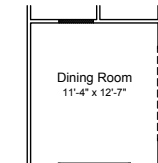

**Dining Room Option I.L.O. Living Room**

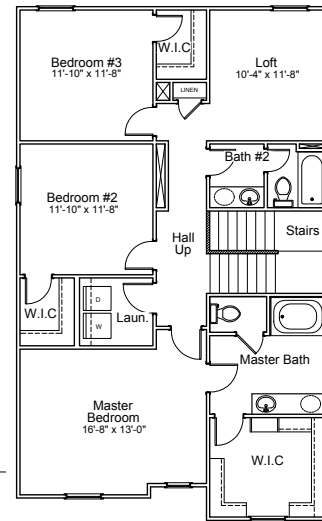

**"A" 2nd Floor Plan**

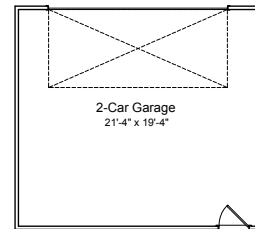

**2-Car Garage Option**

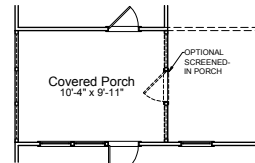

**Covered Porch w/ Garage Option**