

# Joliet C



## INFORMATION ABOUT THIS PLAN:

- 3 Bedroom, 2.5 Baths
- Up to 2,731 SF
- Covered front porch
- Master on main floor
- Upstairs loft
- Options include enlarged covered porch, pet pad, 1 or 2-car garage, guest suite, 4th bedroom, and bonus room



**A**



**B**

# Joliet

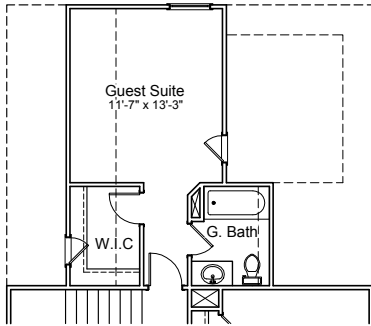

**Guest Suite Option**

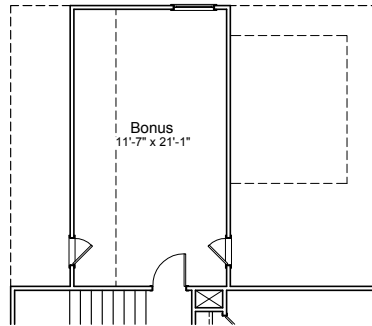

**Bonus Room Option**

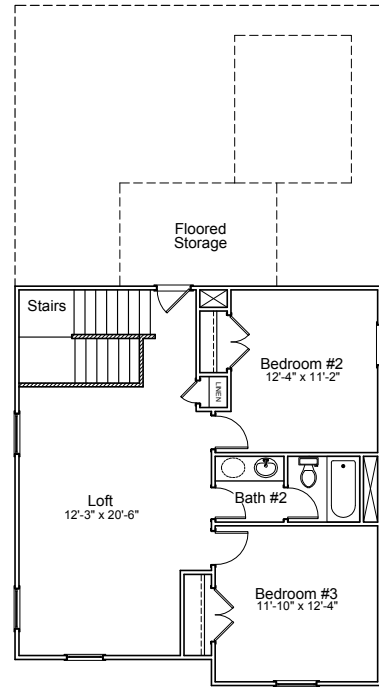

**"A" 2nd Floor Plan**

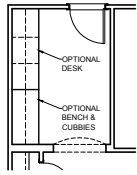

**Family Entry Cabinet Options**



**Pet Pad Option**

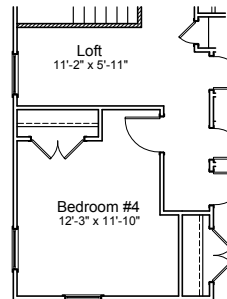

**Bedroom #4 Option**

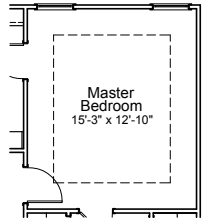

**Boxed Ceiling Option**

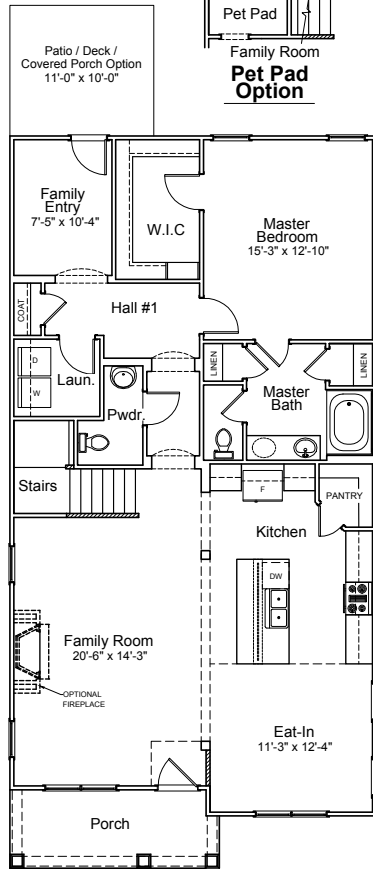

**"A" 1st Floor Plan**

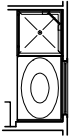

**Tub/ Shower Option**

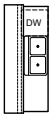

**Raised Bar Option**

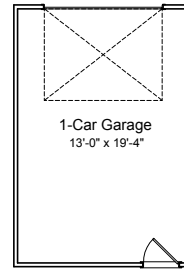

**1-Car Garage Option**

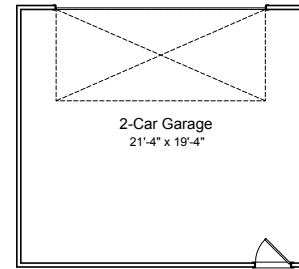

**2-Car Garage Option**

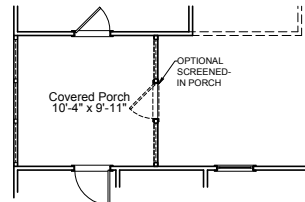

**Covered Porch w/ Garage Option**

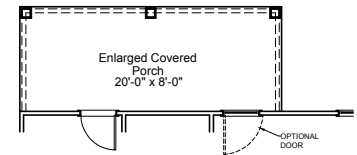

**Enlarged Covered Porch Option  
(Not Available w/ Attached Garage Opts.)**