

Hopewell II C



INFORMATION ABOUT THIS PLAN:

- 3 Bedroom, 2.5 Baths
- Up to 2,515 SF
- Formal dining room
- Open kitchen and family room
- Options include butler's pantry, guest suite, enlarged covered porch, fireplace, pet pad, storage shed, 1 or 2-car garage, and 3rd floor bonus or 2nd guest suite



A



B

Hopewell II

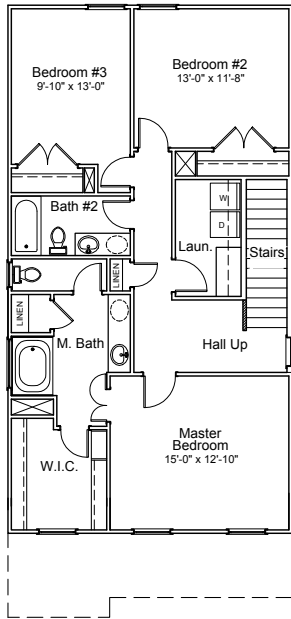

"A" 2nd Floor Plan

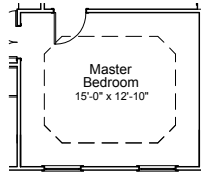

**Box Ceiling Option
@ Master Bedroom**

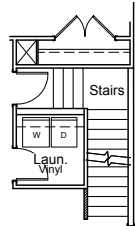

**Stair to 3rd Floor
Bonus Option
@ 2nd Floor**

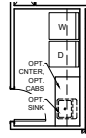

Laundry Options

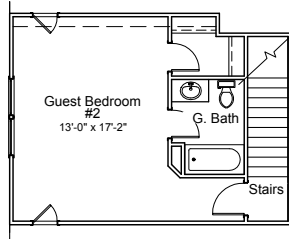

**Guest Suite #2 Option
I.L.O. Bonus Room**

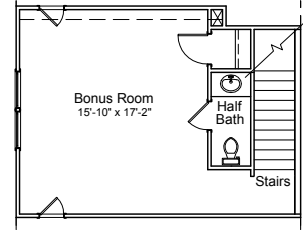

**Half Bath Option
@ Bonus Room**

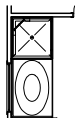

**Tub/Shower
Option
@ Master Bath**

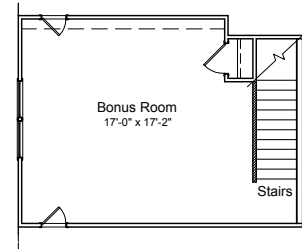

**3rd Floor
Bonus Room Option**

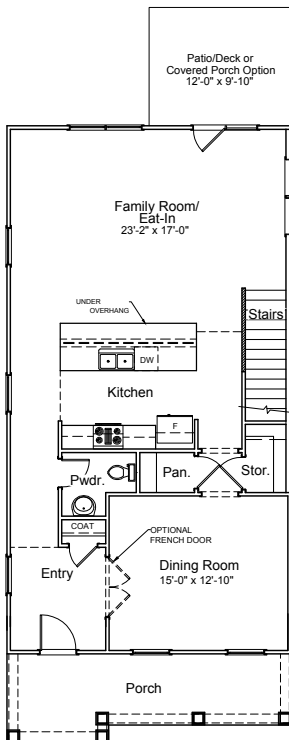

"A" 1st Floor Plan

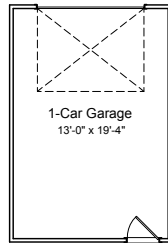

1-Car Garage Option

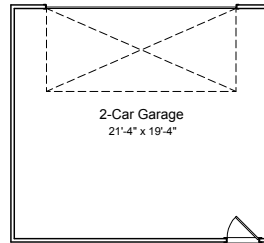

2-Car Garage Option

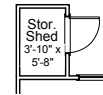

**Storage Shed Option
(Not Available w/ Attached Garage Opts.)**

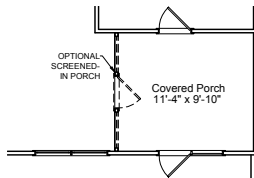

**Covered Porch w/
Attached Garage Option**

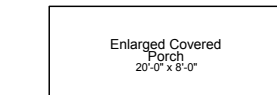

**Enlarged Covered Porch Option
(Not Available w/ Attached Garage Opts.)**

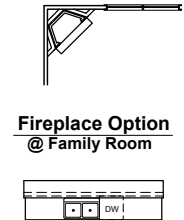

**Fireplace Option
@ Family Room**



**Pet Pad
Option**

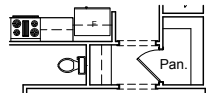

Butler's Pantry Option

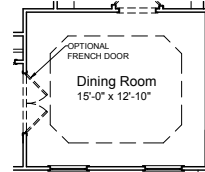

**Box Ceiling Option
@ Dining Room**

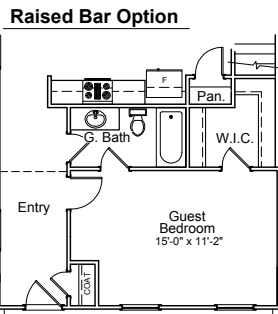

Guest Suite Option



Raised Bar Option